

PEARL R2 AIR SUSPENSION SYSTEM

R2AS / R2AL

Instruction Manual

Congratulations on your purchase!

To get optimum performance from your R2 Air Suspension System, please read this Instruction Manual completely before attempting to assemble or install the Suspension System to your drum.



R2AS



R2AL

COMPONENTS INCLUDED

1. R2 Air Upper Section (x1)

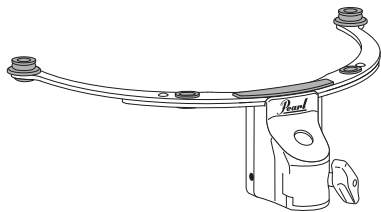

(Illust : R2AL)

2. R2 Air Lower Section (x1)

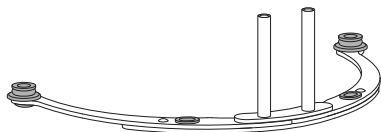

3. DamperDisk (x4)

(When installed, shorten the sustain, the more used, the shorter the note.)

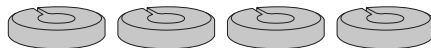

4. Flange Hoop Adapter (x2)

(Use with Flange Style Hoop Only)



5. Hex Set Screw (x2)



6. Hex Wrench (3mm) (x1)



Installation

CAUTION

When installing the R2 Air Suspension System, always use a stable flat surface such as a floor or table. Take care not to damage the instrument or work surface.

1. With the drum on a flat secure surface, loosen and remove the tension rods from the drum and set them aside. Then remove both top and bottom hoops and heads (Fig.1).

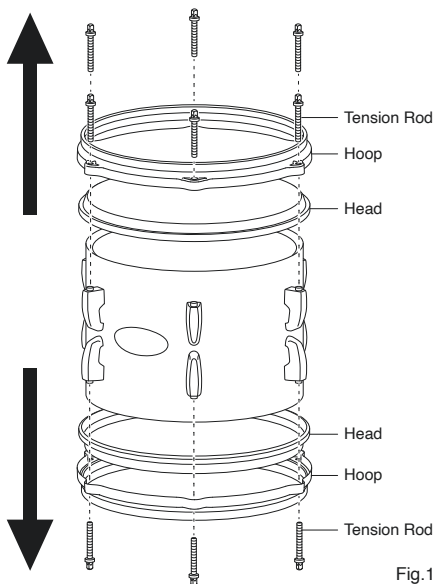

2. How to install the R2 Air Suspension System Upper Section to the batter side of the drum shell. First, place the drum shell on a flat surface with the batter side up. Position the Tom Holder Receiver Body on the desired drum shell panel so that once the drum is placed within your setup, the drum badge will face outward as expected. Double-check to ensure the ResoDisk is facing upward above the respective lugs. Next, install the Batter Head, Die Cast Hoop, and Tension Rods finger tight (Fig.2).

If using Flange Style Hoop, see (Fig.2-A, 2-B) to install the Flange Hoop Adapters.

Once the batter side is complete, flip the drum over for the R2 Air Lower Section installation on the bottom side of the drum shell, step 3.

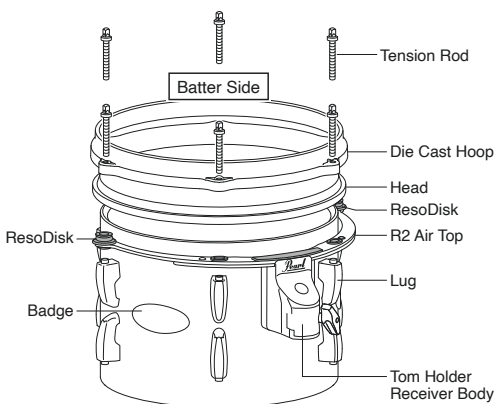

IMPORTANT

When using Flange Style Hoops, the Flange Hoop Adapter must be used to correctly install the R2 Air Suspension System (Fig.2-A, 2-B).

Do not use the Flange Hoop Adapter with Die Cast Hoops.

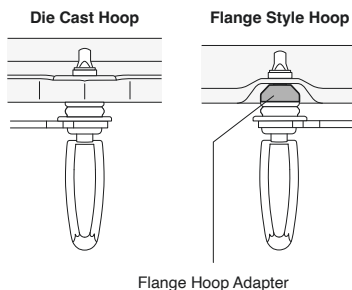

Ensure the flat side of the Flange Hoop Adapter faces toward the head.

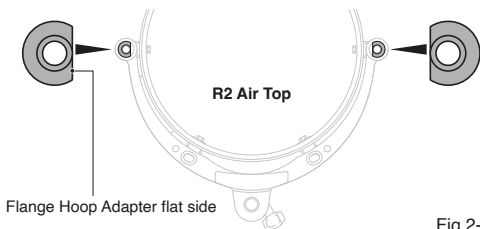

Fig.2-B

3. How to install the R2 Air Suspension System Lower Section to the Upper Section and onto the bottom of the drum shell. Insert the Slide Shafts of the Lower Section into the Upper Section and onto the drum shell (Fig.3).

Check to ensure the top of the ResoDisk faces downward to rest on the top of the respective lugs. Now install the Head, Die Cast Hoop, and Tension Rods finger tight.

Once the bottom side is complete, tune the drum to your desired pitch.

If needed, once the installation is complete, tuning adjustments can be made with the drum on a stand.

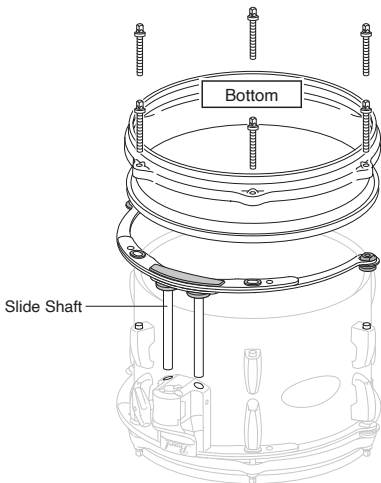

Fig.3

4. To set the depth of the R2 Air Suspension System correctly on your drum, start with the drum tuned and upside down, with the bottom facing upward on a flat surface. Then adjust the bottom Radial Mount Plate downward so the ResoDisk lightly touches the top of the lug. Next, check that the batter side ResoDisk is resting on the bottom of the Die Cast Hoop. Tighten the Hex Set Screws to secure the Slide Shaft into place (Fig.4). Flip the drum over, and the ResoDisk should be set as shown in (Fig.5).

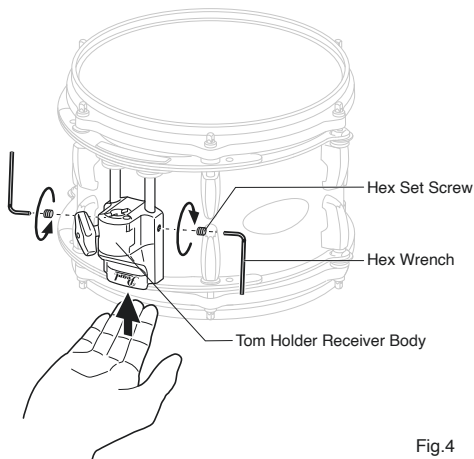

Fig.4

IMPORTANT

When set correctly on the batter side, there should be a small gap between the bottom of the ResoDisk and the top of the batter lug; on the bottom side, there should be a small gap between the bottom of the ResoDisk and the bottom of the Die Cast Hoop.

NOTE

- If using the Flange Hoop Adapter, the top of the adapter should be in contact with the flange section of the hoop, refer to (Fig.2-A, 2-B).
- Do not use the Flange Hoop Adapter on Die Cast Hoops.
- When adjusting the Slide Shaft, you may need to raise the Tom Holder Receiver Body slightly; doing so may cause some noise between the parts, which is normal.

NOTE

- The R2 Air Suspension System depth is adjustable using the Slide Shaft and is set after tuning. See the next step.

5. Next, attach the drum to a tom holder and ensure it is stable and secure and that all four ResoDisk support it correctly, as shown in (Fig.5).

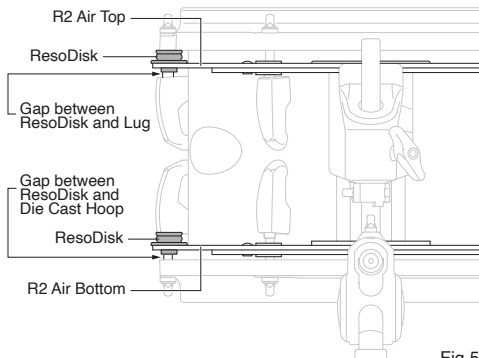

Fig.5

How To Use The DamperDisk

The R2 Air Suspension System provides maximum sustain for your drum. The DamperDisk included allow you to adjust the sustain to a shorter note instead of using gel mufflers or tape.

To install, slide them onto the Tension Rod as shown (Fig.6).

Adjust the Slide Shaft to allow a snug fit between the Radial Mount Plate and lug if needed.

Use one DamperDisk for mild sustain reduction, and add more to reduce it further. DamperDisk placed between the bottom Radial Mount Plate and lugs have a greater effect on the amount of reduction.

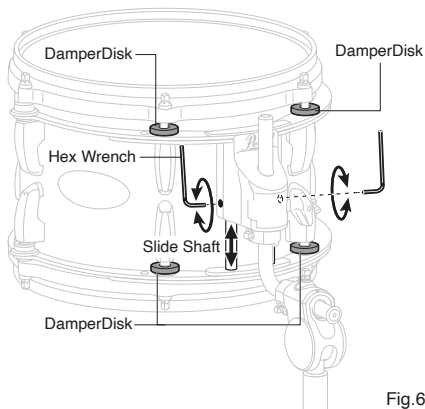

Fig.6

HINT

If there's no need to adjust the sustain, attach them to the bottom of the Slide Shaft for future use (Fig.6-A).

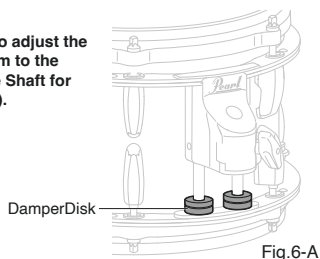

Fig.6-A

CAUTION

- Only use the proper R2 Air Suspension System for the size, the number of lugs, and the depth of your drum.
- For safety, assemble, install or remove the R2 Air Suspension System on a clean, stable surface such as a firm table or on the floor.
- Remove R2 Air Suspension System from the drum to perform maintenance or the installation of replacement parts.
- Avoid excess pressure on R2 Air Suspension System equipped drums to prevent possible damage.
- Avoid hitting or bending the R2 Air Suspension System.
- Ensure that the R2 Air Suspension System is firmly locked to tom stands and tom holders before playing.
- Do not use this product for purposes other than its intended use.
- Not following the above instructions may cause damage to the R2 Air Suspension System, property damage, or personal injury.

California Proposition 65



Pearl

<https://www.pearldrums.com>

Products and specifications are subject to change without notice.

Printed in Taiwan

Dec 2022