



## ⚠ CAUTION

- For best results, installation should be done by a qualified technician. Pearl cannot be held responsible for damages of properties or personal injuries sustained during the installation process by any individual.
- Pearl Warranty does NOT cover damage caused by the installation or use of this product.
- To mount the MXTCMA-1 to your drum requires that four 6.2mm (1/4") holes are drilled into the drum shell.
- Important: Make certain the location of the holes are correct prior to drilling into the shell.

This product is designed to fit Pearl PTDM/PTDML/PTDCC Tenor Drums in 14", 15", and 16" diameters using 8 tension lugs each in conjunction with the SGL-200 Sling. The following instructions pertain to these products only. The installation of this product on any other drums will have to be determined by the end-user.

## Assembly Instructions

1. With the drum on a stable surface, remove both heads/hoops and tension rods. Next, position the drum, as shown in (Fig.1), and remove the four corresponding lugs located under the Eye-Bolts and set all removed parts aside.

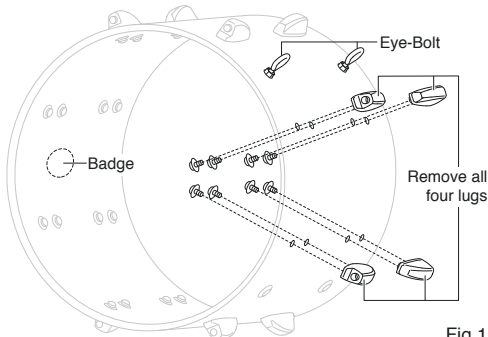

2. Using a light-tack tape, locate and mark all four hole locations as shown in (Fig.2-A) and (Fig.2-B). Use of a carpenter's square is recommended to ensure the holes are spaced 60mm (2.36") on center and in-line with the corresponding lugs.

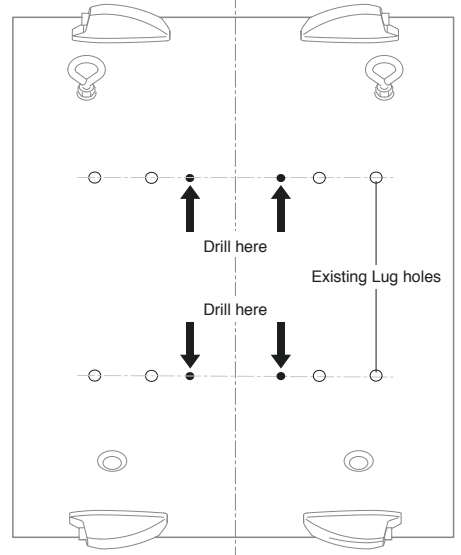

Fig.2-A

Double-check to ensure the four hole locations are correct. If no issues, use a Brad-Point  $\varnothing 6.2\text{mm}$  (1/4") drill bit to drill the holes (Fig.2-B).

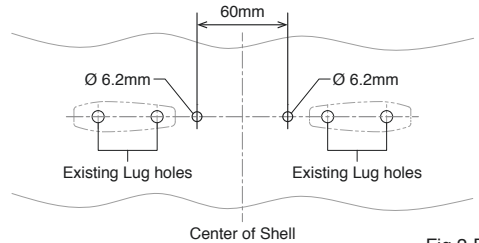

Fig.2-B

- Remove the light-tack tape. Attach the four Mounting Post with Gaskets using the supplied Wrench and a Phillips-Head screwdriver (Fig.3-A).

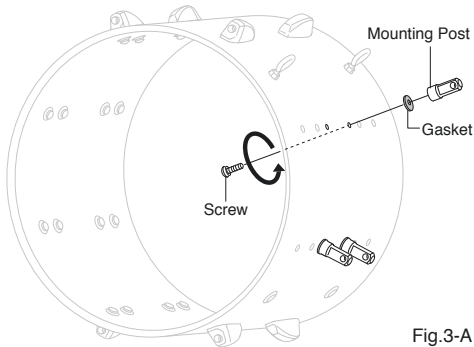

Fig.3-A

**Important:** Using the Wrench provided, be sure to position the "Flat-Surface" of the Mounting Post, as shown in (Fig.3-B) then tighten to secure.

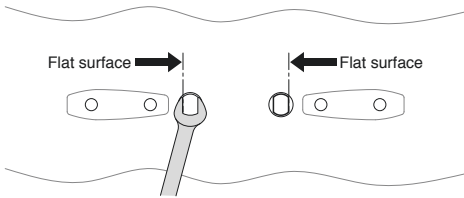

Fig.3-B

- To attach the Chest Mount Carrier w/Bracket to the Mounting Post, align the holes of the Bracket and Bottom Supports to the corresponding outer-holes of the Mounting Post (Fig.4).

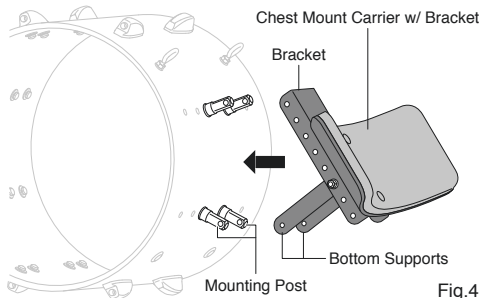

Fig.4

- Insert the remaining four screws and tighten using a Phillips-Head screwdriver to secure (Fig.4-B).

If needed, rotate the Mounting Post to meet flush with the Chest Mount Bracket.

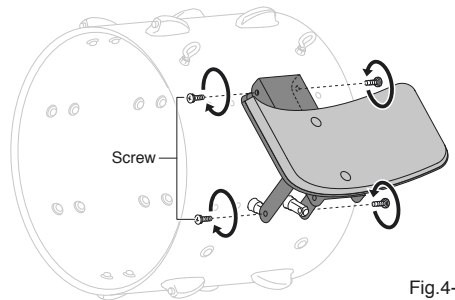

Fig.4-B

- The Chest Mount Carrier features a drum angle adjustment. We recommend the player try the drum on and make any necessary changes to the angle adjustment and Sling (SGL-200) for optimum comfort.

To adjust the drum's angle, reposition the Bracket on the upper Mounting Post and the Bottom Supports on the Bracket through the Angle Position Holes, as shown in (Fig.5).

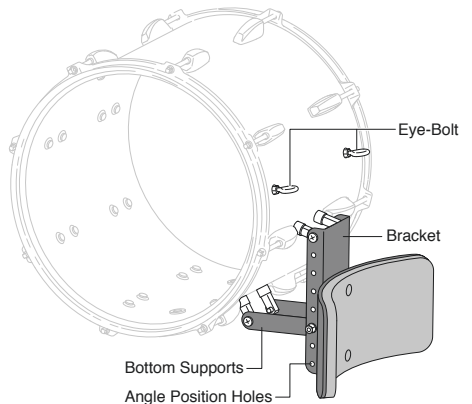



Fig.5

 **CAUTION**

- Periodically check to ensure all screws, and adjustments are tight and secure as they may become loose during normal use. Failure to do so may result in property damage or personal injury.
- Pearl Musical Instrument Company and associates cannot be held responsible for any property damage or personal injury caused by the use of this product.
- Pearl Warranty does NOT cover any damage caused by the use of this product.

California Proposition 65



***Pearl***<sup>®</sup>

<https://www.pearldrums.com>

Products and specifications are subject to change without notice.