

PEARL DRUM PEDAL

P-1000

Instruction Manual

Congratulations on your purchase!
 To get optimum performance of your PowerShifter ProStock Pedal,
 please read this Instruction Manual before playing.

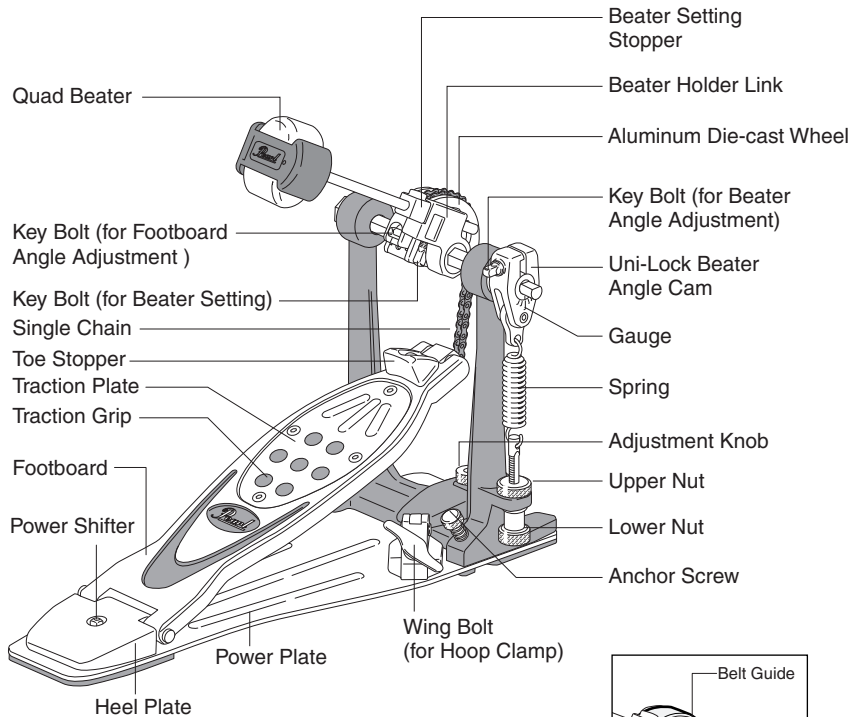

NOTE:
 The P-1000 comes with a Single Chain attached at the factory.

Convertible Single Chain/Belt Drive System

The P-1000 comes with a Single Chain attached at the factory, however, it can be replaced with the included Belt if desired.

Chain Removal

To remove the Chain, remove the Key Bolt and Bolt as shown in Fig. 1

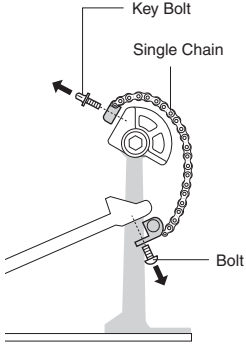

Fig. 1

Belt Assembly

Before attaching the Belt, the Belt Guide must be installed. Install the Belt Guide as shown in Fig.2 using the provided Allen Wrench to tighten the set screw. Do not overtighten.

Next attach the Belt as shown in Fig.3 using the provided Key Bolt and Bolt.

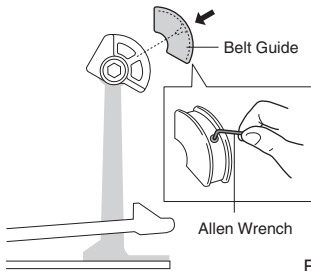

Fig. 2

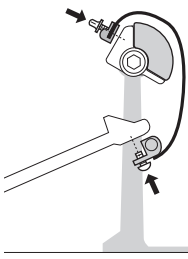

Fig. 3

Quad Beater

The Quad Beater has four striking surfaces, each capable of producing a different sound. Please refer to the following chart to determine the sound best suited to your playing style (Fig.4).

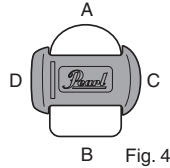

Fig. 4

Surface	Surface Material	Contact Area	Sound
A	Felt	Spot	Warm Sound with Sharp Attack
B	Felt	Line	Warm Sound with Fat Attack
C	Plastic	Spot	Hard Sound with Sharp Attack
D	Plastic	Line	Hard Sound with Fat Attack

Beater Setting

Insert the Quad Beater into the Beater Holder Link with the desired striking surface facing toward the bass drum head and tighten the Key Bolt to set the Quad Beater at the desired height (Fig. 5). To retain the height setting and to keep the Quad Beater from rotating while playing, loosen the Allen Screw on the Beater Setting Stopper with the provided Allen Wrench and slide the Beater Setting Stopper into the notch of the Beater Holder Link (Fig. 6).

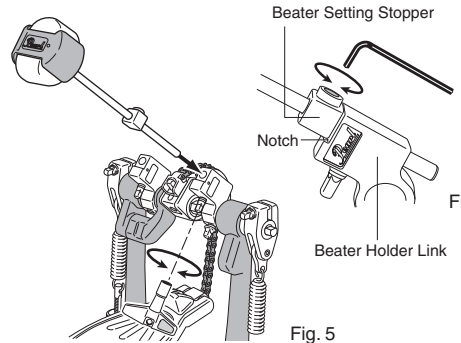

Fig. 6

Fig. 5

Beater Angle Adjustment

The Beater Angle can be adjusted by loosening the key bolt on the Uni-Lock Beater Angle Cam and swinging the beater to the desired angle. Re-tighten the key bolt when the desired angle is achieved. A gauge is provided on the side of the Uni-Lock Beater Angle Cam to aid the setting process (Fig. 7).

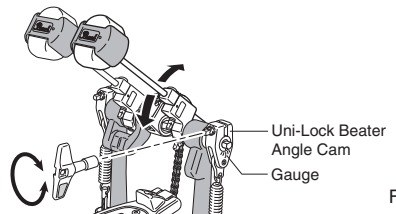

Fig. 7

Footboard Angle Adjustment

The footboard angle is adjustable by loosening the Key Bolt as shown (Fig. 8) and sliding the Drive Connector of the chain or belt to one of three positions and re-tightening the key bolt.

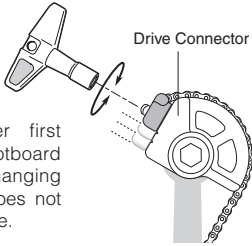

Fig. 8

Note:

Removing the beater first facilitates easier footboard angle adjustment. Changing the footboard angle does not change the beater angle.

Spring Tension Adjustment

To increase the tension of the spring, loosen the Upper Nut and tighten the Lower Nut until the desired tension is achieved. To decrease the tension, loosen the Lower Nut.

This adjustment assembly employs a double nut system to retain tension settings. Before playing, make sure that both nuts are tight. (Fig. 9)

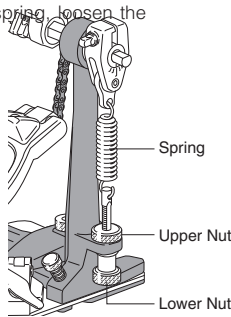
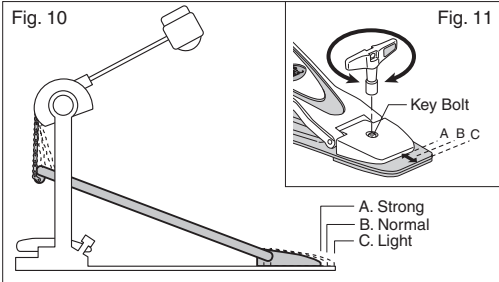

Fig. 9

PowerShifter

The PowerShifter function allows you to change the feel and action of the pedal by shifting the footboard toward or away from the bass drum. To change the PowerShifter setting, loosen the key bolt in the heel of the footboard and move the footboard to the desired position: A, B or C. Re-tighten the key bolt (Fig. 10,11).



Caution

The heel must be flush with the Power Plate, or damage to the pedal may result.

Traction Plate and Traction Grip Adjustment

The Traction Plate is reversible to provide just the right amount of grip at either the front or rear of the footboard. The Traction Grip dots can be removed as needed to custom tailor the amount of traction for your personal playing style. For either adjustment, remove the four Allen screws holding the Traction Plate with the included Allen Wrench. The Traction Plate can then be reversed, the Traction Grip dots removed and rearranged, or both. Note: When reattaching the Traction Plate, finger-tighten the four screws to prevent cross-threading then tighten the screws securely. (Fig. 12,13)

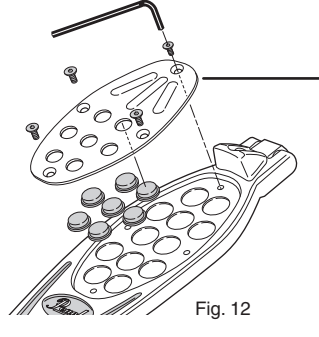

Fig. 12

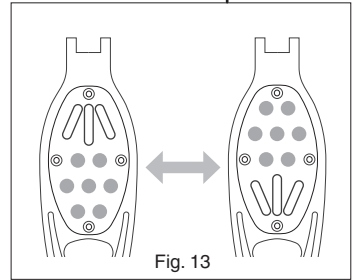

Fig. 13

Caution

Always use the pedal with the Traction Plate mounted to prevent possible injury to your foot.

Toe Stopper

The Toe Stopper prevents your foot from sliding into the chain or belt while playing. If you prefer, it can be easily removed by undoing the key bolt as shown in (Fig. 14).

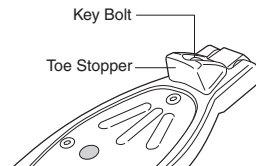

Fig. 14

Hoop Clamp System

To attach your pedal to the bass drum, slide the bass drum hoop between the Hoop Clamp and the bottom lip of the pedal. Square the pedal then tighten the Wing Bolt to secure the pedal to the bass drum. If the bass drum hoop doesn't fit or if the heel of the pedal jumps up while playing, loosen the Allen screw with the provided Allen wrench and turn the Adjustment Knob to compensate. Securely tighten the Allen screw when done. (Fig. 15)

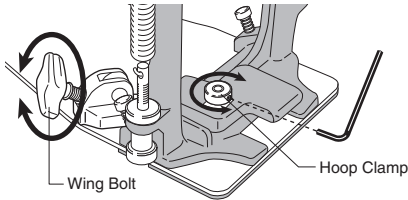

Fig. 15

Anchor Screw

Turn the Anchor Screws clockwise to help prevent your bass drum from sliding. (Fig. 16)

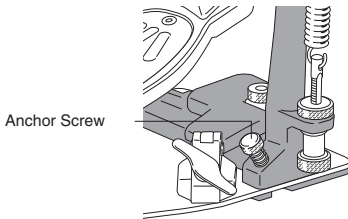

Fig. 16

⚠ Caution

The tips of the Anchor Screws are sharp thus it is **HIGHLY RECOMMENDED** to use a rug or carpet to protect floor surfaces.

⚠ Caution

- ◆ Take care when handling or moving the fully assembled Twin Pedal to prevent damage to the Drive Shaft and its components.
- ◆ Periodically check all Allen Screws for tightness and tighten them with the provided Allen Wrenches as needed.
- ◆ Periodically apply lube to all moving parts such as the Chain, Cam Roller, Footboard Hinge, etc. for optimal speed and extended life of your pedal. Bearings should be lubricated with grease, not liquid oil.
- ◆ To maximize traction of the rubber mats underneath the PowerPlate, keep them clean and dust free using a damp cotton towel.

Pearl[®]

<http://www.pearldrums.com>

Products and specifications are subject to change without notice.

Printed in Taiwan.

-0710-